

Bayfair Center

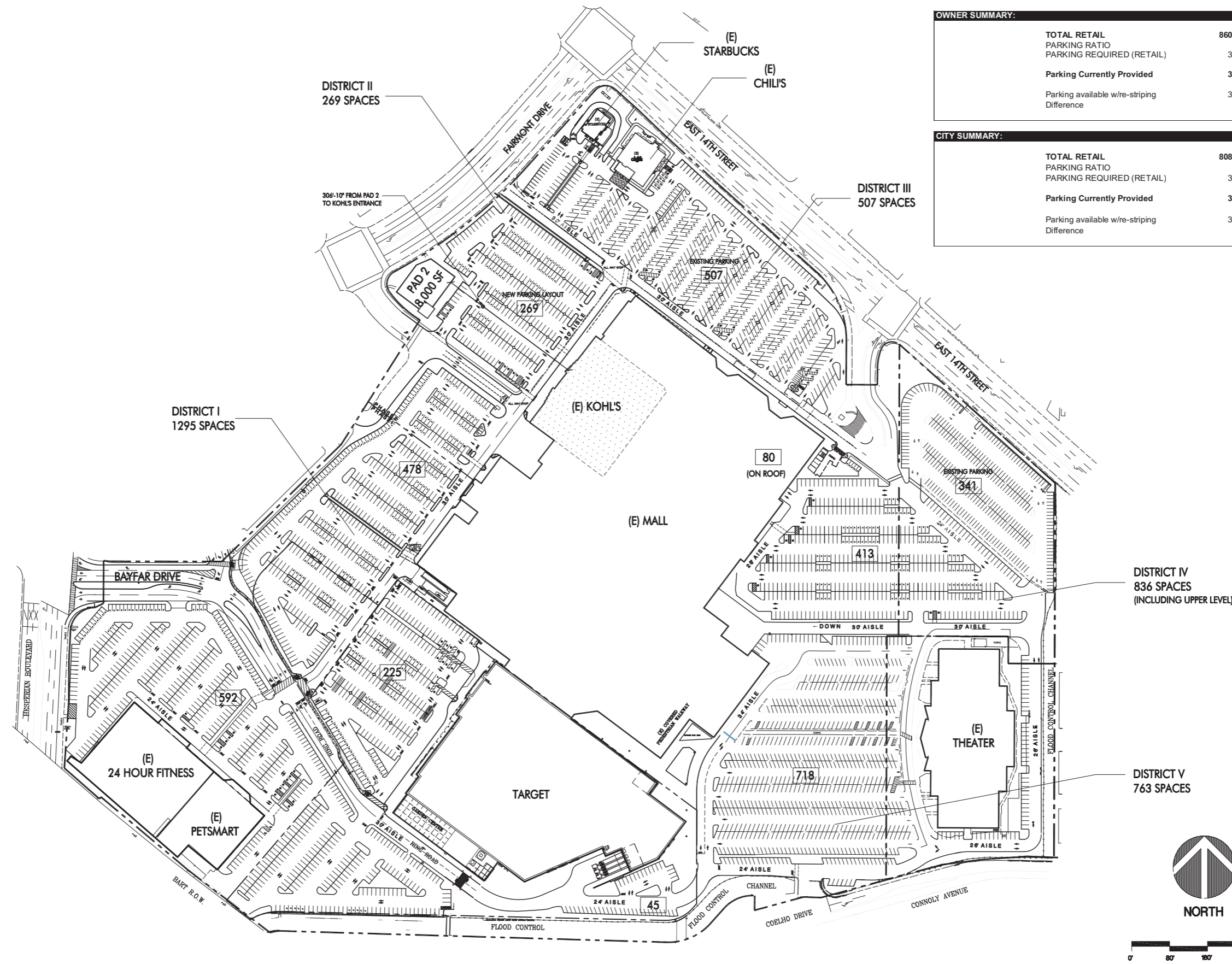

OWNER SUMMARY:

TOTAL RETAIL	860,764 SF
PARKING RATIO	4.3 /1000 SF
PARKING REQUIRED (RETAIL)	3,701 Spaces
Parking Currently Provided	3,505 Spaces
Parking available w/re-stripping	3,668 Spaces
Difference	(33) Spaces

CITY SUMMARY:

TOTAL RETAIL	808,360 SF
PARKING RATIO	4.3 /1000 SF
PARKING REQUIRED (RETAIL)	3,476 Spaces
Parking Currently Provided	3,505 Spaces
Parking available w/re-stripping	3,668 Spaces
Difference	192 Spaces



SCALE: 1"=80'-0"